

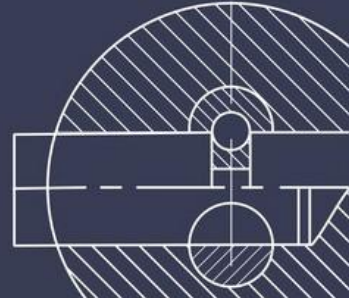

# LIST OF MINI LOCKS

**Electromechanical locking mechanisms**  
**With a wide range of applications in the field of**  
**Access Restriction and Control Systems**



**Promix-SM101**

It can be applied to doors. The lock blocks the corner of the door and is mounted in the upper edge of the door frame. By the type and place of installation, it serves as an analogue of an electromagnetic lock.



**Promix-SM102**

The unique ratio of the overall dimensions of the holding force and the current consumption, universal mount. The lock can be used in many areas. UNIQUE of its kind.



**Promix-SM104**

The lock is designed for installation on lockers, built-in wardrobes, locker rooms, boxes for storing documents, etc.



**Promix-SM112**

Miniature dimensions and design features allow the lock to be used to restrict access to various commercial furniture



**Promix-SM131**

Two modifications for flush and surface mounting. Compact dimensions.



**Promix-SM203**

Designed for locking swing doors, gates and wickets, with the possibility of remote opening from

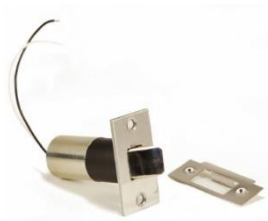

## Promix-SM213

Designed for locking swing doors, gates and gates located in the open air, with the possibility of their remote opening



## Promix-SM305

Designed to lock hinged plastic doors and windows, with the ability to remotely open them using controllers of access control and management systems



## Promix-SM306

Designed for use as an actuator as part of an access control system (ACS) for locking doors of offices and administrative premises



## Promix-SM308

Designed to restrict access to lockers (post office), boxes for storing documents, lockers in locker rooms of fitness clubs, schools, enterprises with the possibility of remote opening.



## Promix-SM323

Designed for use in storage rooms, postmates, locker cabinets in schools, fitness centers, etc.



## Promix-SM491

Miniature size. can be used to restrict access to: lockers, built-in wardrobes, retail equipment, drug and chemical storage cabinets, ATM machines, vending machines, etc.

**ArtGuard Security**

The Point where Life & Science interact



The warranty for products is 12 months, if necessary, warranty replacement and warranty repairs are made, in the post-warranty period, repairs are also carried out at the enterprise.

Advisory customer support for the installation and operation of equipment.

The product meets the EAC standards, CE